

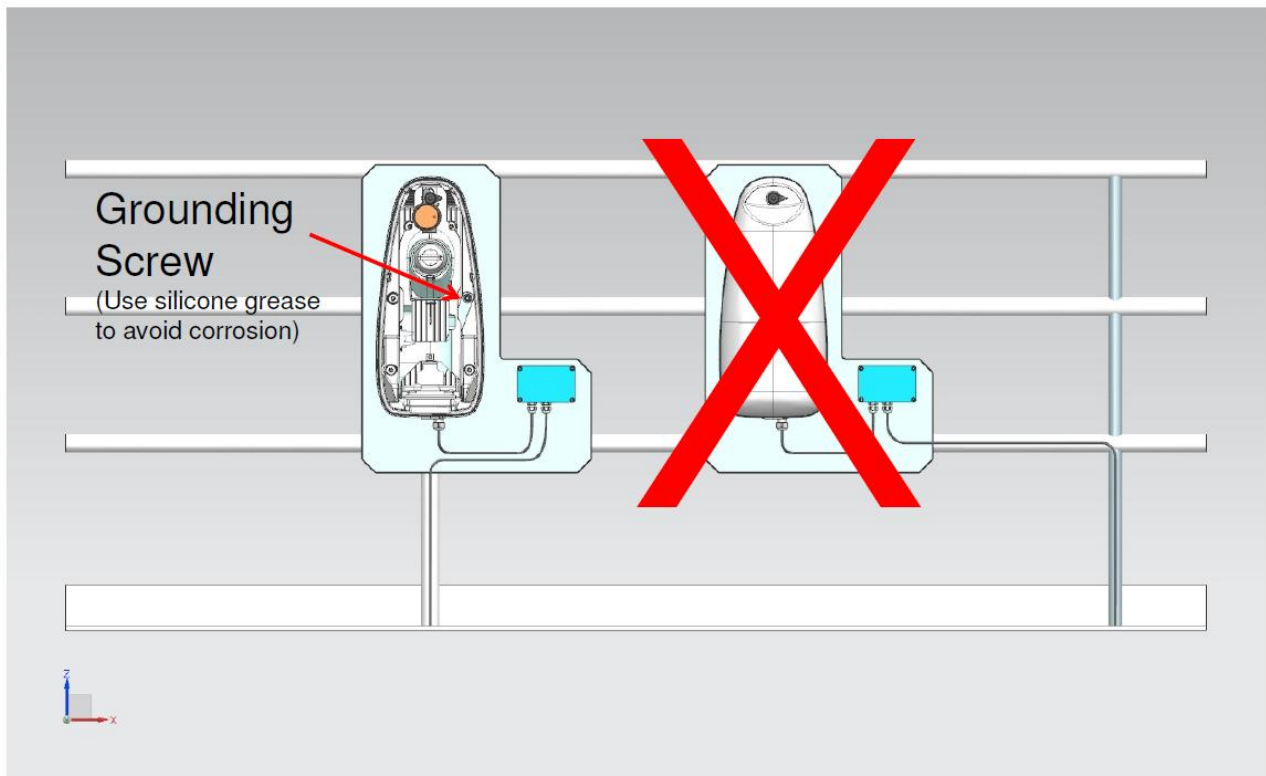

TECHNICAL BULLETIN TB01-2015 rev. 1

Regarding: Mounting Tron 40VDR

The Jotron Tron 40VDR is a combined GMDSS EPIRB and float free VDR storage module compliant with both latest EPIRB and VDR performance standards [IMO A.810\(19\)](#), and [MSC. 333\(90\)](#). To be compliant as a GMDSS EPIRB, it is important to follow COMSAR regulation on mounting, [COMSAR/Circ.32](#) (chapter 4.10, page 23)



In addition, it is important that the Tron 40VDR is mounted **VERTICALLY** to ensure a good connection to the bracket module. This is important, to ensure reliable communication with the on-board VDR (Voyage Data Recorder) computer.

Also note above drawing which shall indicate that shortest possible trace of chassis ground to hull ground shall be used when mounted (Mount on/close to vertical pole if mounted on railing as seen here) .

Also important to be mounted on a steel plate if sea spray can enter from behind the bracket.



Please also ensure that the steel hull or plate where the bracket is mounted is completely flat (nor curved or uneven).

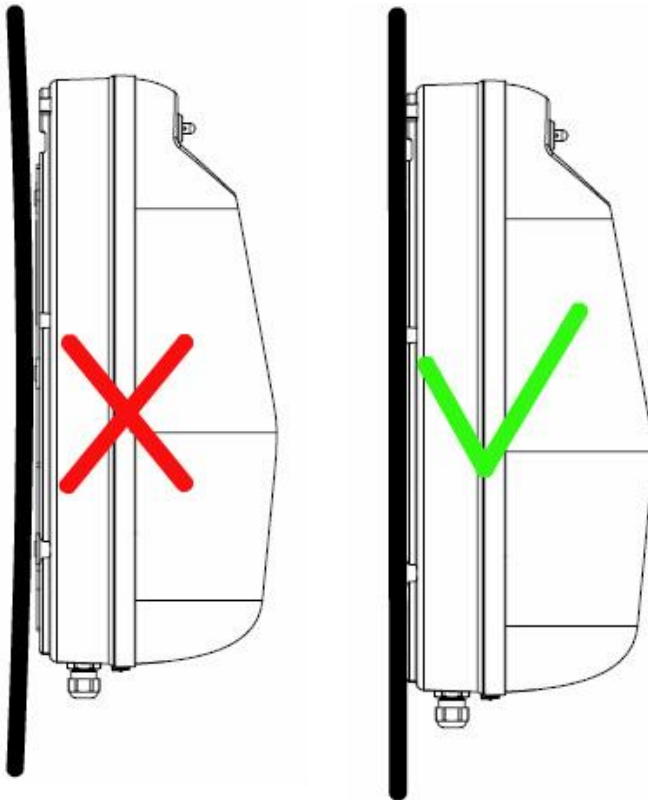

If it's uneven, the bracket will be in tension, and the Tron 40VDR Capsule may not be in good contact with the docking module in the lower part of the bracket:



If it's a gap as shown on the left picture above, communication between VDR computer and Storage module of the beacon may be intermittent or in worst case – No communication!



Mandatory use of Silicon grease

The Würth silicon grease, our P/N: 88237 shall be applied evenly on both surfaces as seen on pictures below, not more than necessary to prevent water to ingress in between beacon and Docking module. The grease will ensure good communication over the contact less Ethernet between Docking module and Storage module (Final Recording Medium [FRM]) of the beacon.



Apply the grease evenly in a thin layer as seen on the pictures on both the Docking and the Storage module (FRM- Final Recording Medium)

Only use grease in the areas surrounded by the green line drawn on the pictures below.

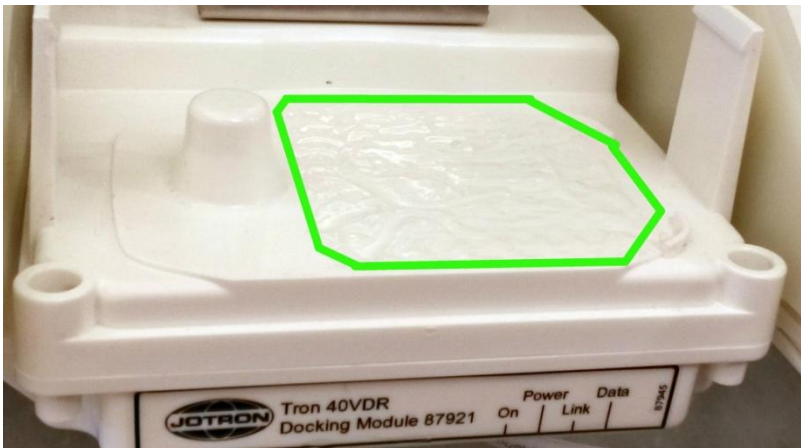



Verify correct placement within bracket



If all the above instructions are taken into account when mounting the Tron 40VDR, a fault free system should be the result!